



Learning Is Our Mission

Honor the Past

Confront the Present

Embrace the Future



Referendum I: On Time and on Budget Promises Kept

10 Reasons the Pieces fit the Puzzle

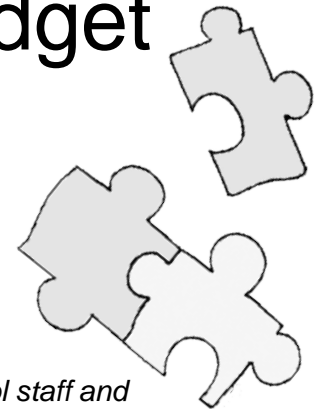

1. The referendum will preserve the historic nature of our High School...and did you know our freshmen class will be the 100th graduating class in 2016!

2. The referendum will create more space in the elementary and middle school for remedial services for our most at-need students.

3. The referendum will provide an independent learning facility for our current Pre-K and Kindergarten students to increase student learning at the most critical times in their lives. This will increase district instructional space in the least expensive manner with the greatest long term gain on our investment.

4. The referendum will offer our high school students two state of the art science and agricultural laboratories and prep rooms.

5. The referendum will move our 5th grade students to the Mary Shoemaker School into a better-suited elementary school setting for learning.

6. The referendum will allow our middle school staff and students to run on an independent schedule from the high school.

7. The referendum will let our middle school and high school sport teams have the ability to practice more due to the multi-purpose gymnasium/cafeteria...and yes it is a regulation size floor.

8. The referendum will allow community sport organizations to have access to a regulation size gymnasium for evening and weekend games and practices.

9. The referendum will allow better scheduling for ALL high school and middle school classes, due to the ability to schedule physical education classes, science classes, and lunch periods at any time during the school day.

10. This referendum addresses many of the same needs that past referendums proposed by building a \$67 million new High School or a \$27 million new middle school. This plan addresses most of those same needs for ONLY \$9.9 million.





Return on Investment

Science Lab



Agricultural Science

Multi-Purpose Room

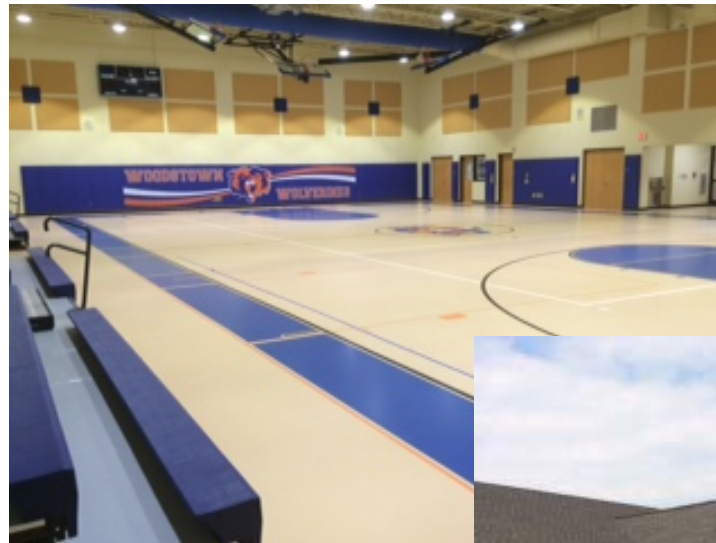

Early Childhood
Learning Center





REFERENDUM II

Restoration = Preservation



HS/MS - 100 Yrs. Old / MSS - 60 Yrs. Old



REFERENDUM II

Continue Investing In Order
To Preserve And Sustain Viability
Versus Obsolescence and Deterioration

“Restoration Equals Preservation”



REFERENDUM II

**Bringing our buildings up to modern standards
(restoration)
will make them vibrant and viable for years to come
(preservation)
and thus make economic sense in that
it secures our buildings for the viable future and
we will not have to build new buildings**



Viability v. Obsolescence /Deterioration

Building Needs to be Modernized
in Order to be Functional Into the
21st Century ... Or else.



Act Now

Limited Time Only!

40% of costs from a NJDOE ROD Grant

As we communicated in the first referendum the cost of these renovations are being funded by 40% from State ROD grants. We didn't include this work in last referendum because we wanted to wait for the funding to become available. It will only be here for a short time. We must seize the opportunity now in order for it be economically advantageous to the taxpayer.

Carpe Diem



New Investment Opportunity

	TOTAL	State Grant	State %	Local Share
High School/ Middle School	\$17.8M	\$7.1M	40%	\$11.9M
Mary Shoemaker School	\$ 1.9M	\$.7M	40%	\$ 1.1M
TOTAL	\$19.8M	\$ 7.9M	40%	\$11.9M



Mary Shoemaker School \$1.1M

Protecting our investment

New Roof and Exterior Doors

Updating Interiors for ADA Code Compliance

Renovated Bathrooms

Restoring Critical Systems

Heating, Ventilating and Air Conditioning Renovation



High School/ Middle School \$11.9

Protecting our investment

New Roof, new Exterior Doors and Windows

Updating Interiors for ADA Code Compliance

Renovated Bathrooms

Auditorium Seating Replacement

Restoring Critical Systems

Heating, Ventilating and Air Conditioning Renovation

Electrical System Upgrade

Woodstown-Pilesgrove

Regional School District

REFERENDUM II: Nov. 4, 2014 Restoration & Preservation



Aerial Roof Plan



Exterior Doors



Exterior Windows require replacement

LEGEND / SCOPE OF WORK

EXTERIOR RENOVATIONS

ROOF REPLACEMENT (APPROX. +/- 60,154 S.F.)

The scope includes the following:

Complete tear off and removal existing roof system down to the structural deck.
Provide new roofing system complete with metal fascias, soffits, and all appurtenances as required for a fully warranted roofing system - 1915 section Area 4, 1950 section 17, 18, 19, 22 and 1983 section Area 24.

ROOF RESTORATION (APPROX. +/- 6,250 S.F.)

The scope includes the following:

Existing roofing system to remain. Provide (2) coats of White Roof Restoration Coating as per Mfr's requirements for a fully warranted roofing system - 1938 section Areas 5 and 8, 9-12..

Existing Conditions

Woodstown-Pilesgrove

Regional School District

REFERENDUM II: Nov. 4, 2014

Restoration & Preservation



LEGEND / SCOPE OF WORK

WINDOW REPLACEMENT

The scope includes the following:

- Provide new approx. (248) windows throughout the entire building - all sections except 1983 section.

EXTERIOR DOOR, FRAME AND HARDWARE

REPLACEMENT TYPICAL FOR (APPROX. +-20)

The scope includes the following:
all sections except 1983 section.

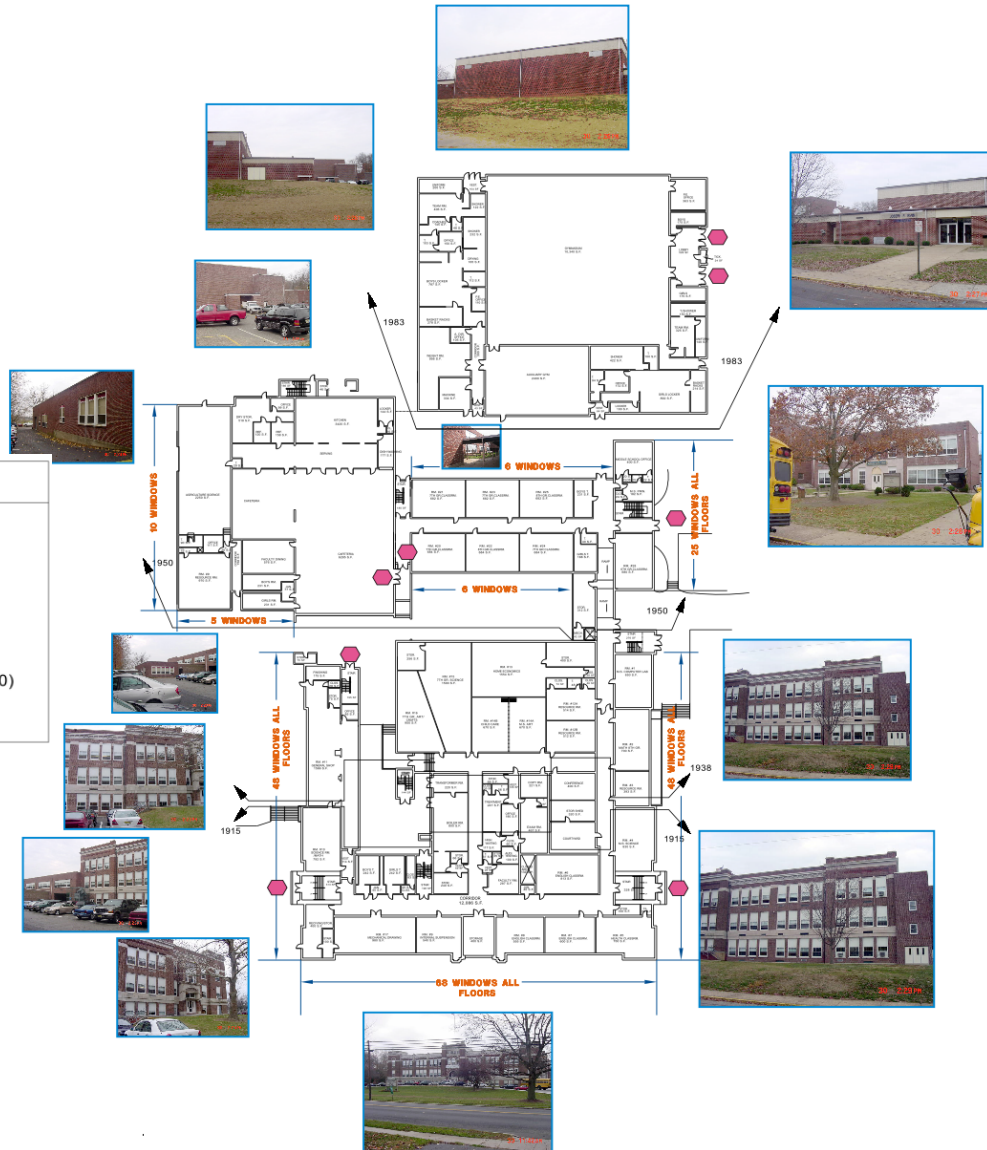

Woodstown-Pilesgrove

Regional School District



REFERENDUM II: Nov. 4, 2014 Restoration & Preservation



Aerial Roof Plan

LEGEND / SCOPE OF WORK

EXTERIOR RENOVATIONS

ROOF REPLACEMENT (APPROX. +/- 34,000 S.F.)

The scope includes the following:

Complete tear off and removal of existing roof system down to the structural deck.
Provide new roofing system complete with metal fascias, soffits, and all appurtenances as required for a fully warranted roofing system.



**N.I.C. = NOT IN CONTRACT
AREAS A,B,C,E & H**



Exterior Doors

Shoemaker Elementary School Existing Conditions



What will the Bond look like? (Local Share)

- Amount of Bond: \$11,907,000
- Bond Term: 20 Years
- Borrowing Rate: 3.10%

(Assumptions based of Phoenix Advisor's projections)



Tax Impact: Sending Districts

	Oldmans	Upper Pittsgrove	Alloway
Total Interest	\$ 45,156	\$ 590,787	\$ 568,209
Average Interest Per Year	\$2,258	\$ 29,539	\$ 28,410
2016	\$3,584	\$46,892	\$45,100
2017	\$3,584	\$46,892	\$45,100
2018	\$3,492	\$45,690	\$43,943
2019	\$3,390	\$44,351	\$42,656
2020	\$3,284	\$42,972	\$41,329



Tax Impact: Member Districts

	Woodstown	Pilesgrove
Assessed Value of Average Home:	\$ 216,600	\$ 281,110
Average Annual Tax Impact:	\$214.54	\$272.67
Average Monthly Tax Impact:	\$ 17.88	\$ 22.72
Tax Per \$100,000 of Assessed Value		
\$100,000	\$99.00	\$97.00
\$200,000	\$198.00	\$194.00
\$300,000	\$297.00	\$291.00
\$400,000	\$396.00	\$388.00

Woodstown-Pilesgrove

Regional School District



REFERENDUM II: Nov. 4, 2014 Restoration & Preservation

Restoration and Preservation
It's On Sale at 40% off
Promises were kept: Referendum I
Return on Investment is ongoing
New Investment Opportunities
Tax Burden is Shared

COULD YOU
SUMMARIZE
THE MOST
IMPORTANT
PARTS?





Community Meeting

There will be a Public Hearing on

Thursday, October 23rd

at 7 PM in the

New Middle School

Multi-Purpose Room





Restoration = Preservation



Save the date!
Tuesday
November 4th



Avg. Tax Impact
\$215-\$275 per year
\$18-\$23 per month

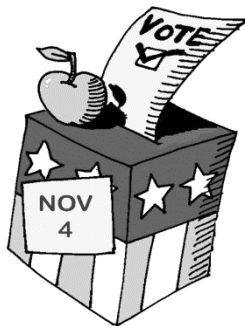

Come Out and VOTE
6AM – 8PM



Exterior Envelope
Energy & Environment
Critical Systems
Select Interiors for Code